

# NTC3 MIP CVD INSTALLATION

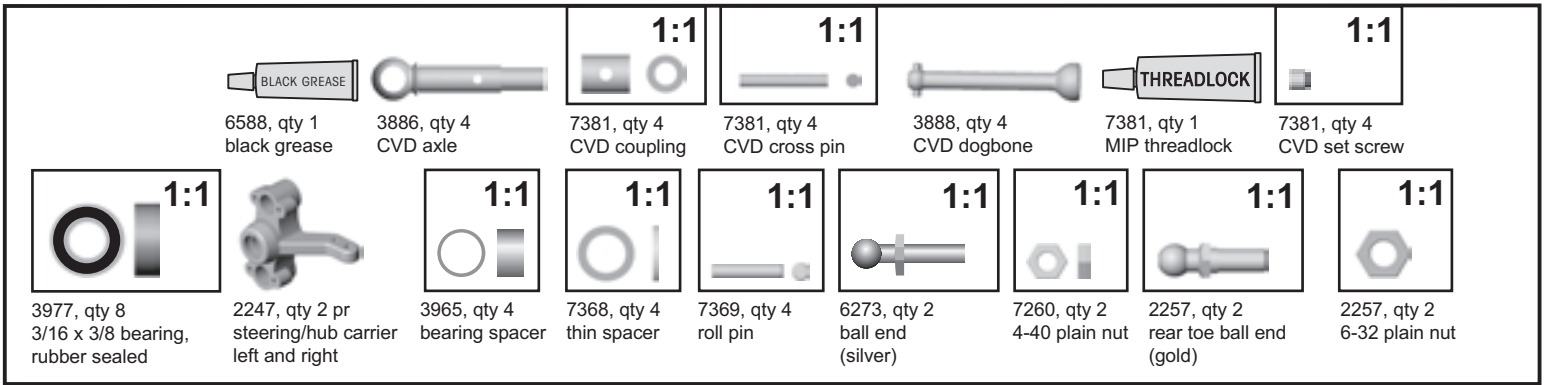

## CVD ASSEMBLY

- Spread some Associated #6588 black grease inside the #3886 axle hole where shown, then on the #7381 coupling and insert the coupling into the axle.
- Slide the #3886 axle into the #3888 dogbone, aligning the cross pin holes.
- Insert the #7381 cross pin, making sure it is evenly spaced on both sides of the dogbone.
- Add a small drop of MIP thread lock to the #7381 set screw. Angle and turn the CVD so the set screw can be screwed in with the Allen wrench.
- Repeat steps for the three remaining CVDs.

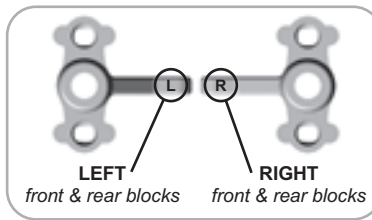

## STEERING / HUB CARRIER ASSEMBLY

- Slide one #3977 bearing onto the axle. Slide the axle assembly into the back of the #2247 steering/hub carrier
- Slide in a #3965 bearing spacer
- Install the second #3977 bearing into the steering / hub carrier, followed by one #7368 thin spacer.
- Insert the #7369 roll pin into the axle.
- Repeat steps 6-9 for the three remaining steering / hub carriers.
- FRONT:** Thread a #6273 ball end into the bottom of one right and one left steering / hub carriers for the front. Add a #7260 plain nut.
- REAR:** Thread a #2257 rear toe ball end into the bottom of one right and one left steering / hub carriers for the rear. Add a #2257 large plain nut.

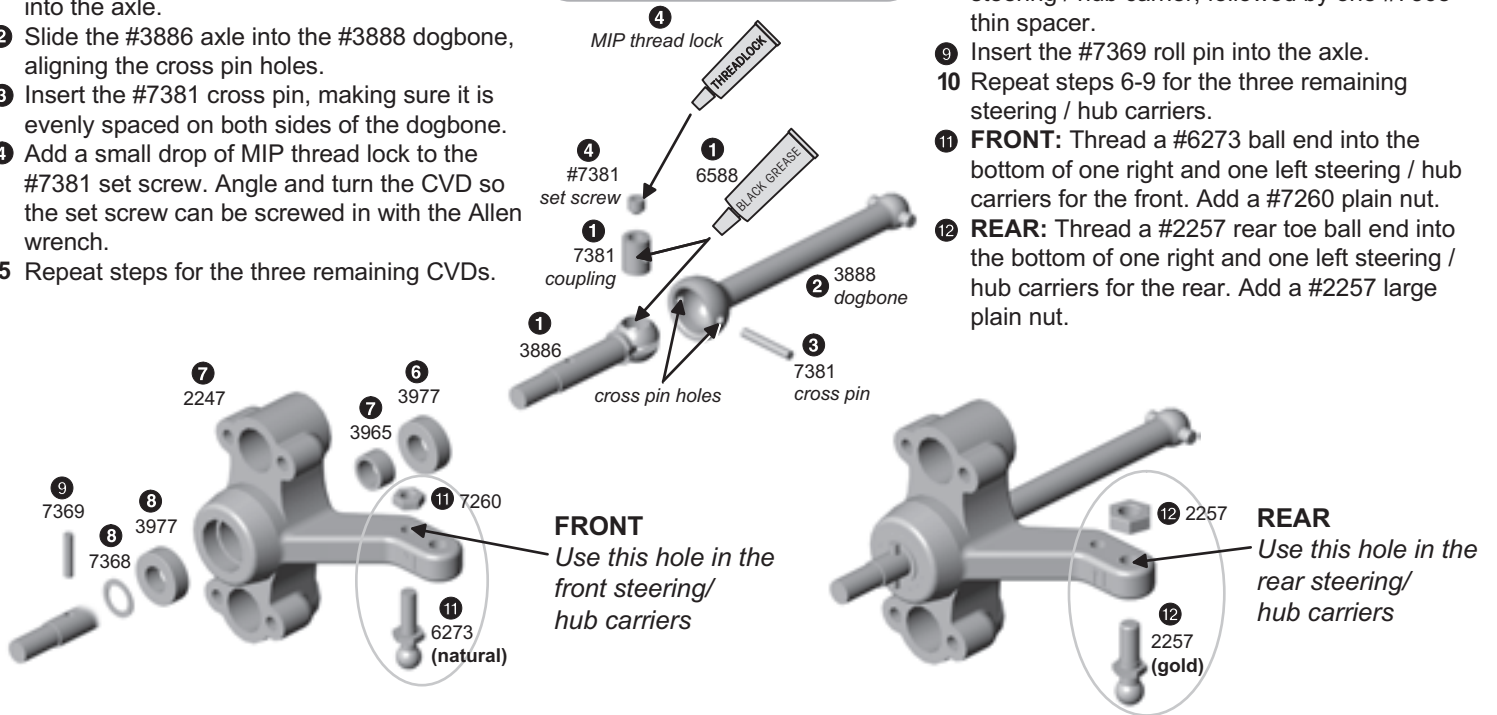

These steps are found in the NTC3 instruction manual, page 13.

**TEAM ASSOCIATED**  
3585 Cadillac Ave.  
Costa Mesa, CA 92626



phone: (714) 850-9342  
fax: (714) 850-1744  
web site: <http://www.teamassociated.com>